

## 770144-1 Product Details

---

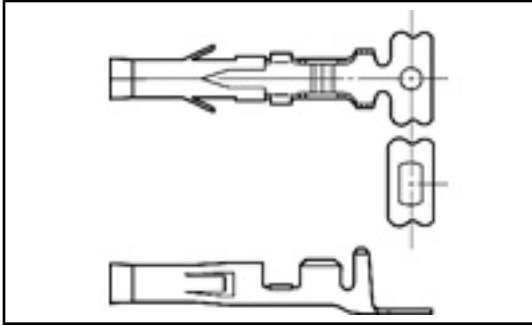

**770144-1**

TE Internal Number: 770144-1



[Active](#)

**.198, .200, .250" Centerline, 250 V,  
13 A max.**



[Always EU RoHS/ELV Compliant \(Statement of Compliance\)](#)

### **Product Highlights:**

- Contact
- Socket
- Pre-Tin Solder Tail Contact Plating
- Packaging Method = Loose Piece
- Wire Range = 0.50-2.00<sup>2</sup> [20-14] mm [AWG]

[View all Features](#)

## Documentation & Additional Information

### Product Drawings:

- [SOCKET, .093, LOOSE PIECE, COMMERCIAL PIN AND SOCKET](#) (PDF, English)

### Catalog Pages/Data Sheets:

- [SOFT SHELL PIN SOCKET CONNECTORS STANDARD DENSITY](#) (PDF, English)

### Product Specifications:

- [Connector, Commercial, Pin & Socket .093 Dia](#) (PDF, English)

### Application Specifications:

- [.093 Diameter Pin and Socket Contacts and Housings](#) (PDF, English)

### Instruction Sheets:

- None Available

### CAD Files: ([CAD Format & Compression Information](#))

- [2D Drawing](#) (DXF, Version F)
- [3D Model](#) (IGES, Version F)
- [3D Model](#) (STEP, Version F)

[List all Documents](#)

### Related Products:

- [Tooling](#)
- [Housings \(69\)](#)

## Product Features (Please use the Product Drawing for all design activity)

### Product Type Features:

- Product Type = Contact
- Gender = Socket
- Wire Insulation Diameter (mm [in]) = 3.56 [0.140]
- Connector Line = Commercial Pin and Socket
- Comment = Pins or Sockets may be used in either the plug or receptacle housings.; Contact Insertion Tool No. 91002-1 (IS 408-7347); Extraction Tool No. 458994-3 (IS 408-9923)

### Electrical Characteristics:

- Voltage (VAC) = 250
- Current Rating (Amps.) = 13
- High Current = No

### Termination Related Features:

- Solder Tail Contact Plating = Pre-Tin

### Body Related Features:

- Wire Range (mm [AWG]) = 0.50-2.00<sup>2</sup> [20-14]
- Contact Diameter (mm [in]) = 2.36 [0.093]
- Stock Thickness (mm [in]) = 0.25 [0.010]

### Contact Related Features:

- Contact Base Material = Brass

### Industry Standards:

- [RoHS/ELV Compliance](#) = RoHS compliant, ELV compliant
- [Lead Free Solder Processes](#) = Not relevant for lead free process
- RoHS/ELV Compliance History = Always was RoHS compliant

### Packaging Related Features:

- Packaging Method = Loose Piece

### Other:

- Brand = AMP